

Lockey Digital Door Locks



Since 1982

Invented & manufactured in Japan, the original brand digital door lock of it's design, distributed in the UK & worldwide since 1982.

For long lasting 'reliable performance' 'renowned for quality'

The Lockey Digital door lock range offers the perfect solution for keyless & wireless mechanical locking systems.

Designed to eliminate the need for keys, minimise installation & maintenance costs, whilst still continues to be one of the most convinient ways to control access at home and in the work place over 25 years on.

Our objective has always been to supply quality products, having undergone rigerous testing and subjected to strict quality control our Lockey Digital door locks are recommended when the need for quality and reliability rises above the the dreaded cost factor.

Our comprehensive range ensures the majority of your access control lock requirements are covered, in addition to general door control 'Lockey Digital locks' are an ideal way to stop unwanted entry through virtually any type of external entrance doors & gates, internal doors & cupboards etc requiring restricted access for many number of reasons for example to protect valubles, to lock away dangerous substances or equipment, to safe keep personal or business documents, this list is not exhaustive, or just simply having had enough of carrying a bunch of keys!

One of our latest new products offers an alternative for when it is not viable to use a 'Lockey Digital door lock' our 'Lockey Key Safe' is a safe solution for key sharing & key storing. Designed utilising an existing Lockey product, our 'Little Lockey' to ensure Lockey quality, reliability & performance.

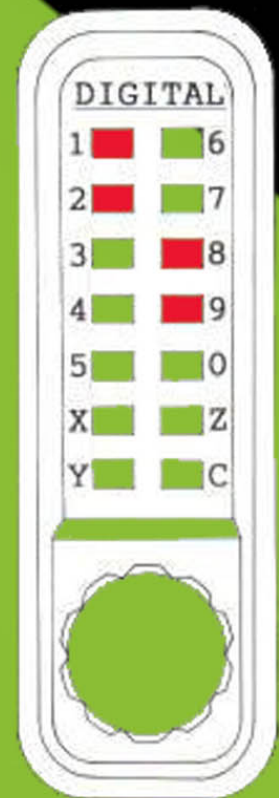

www.lockeydigitaldoorlocks.co.uk,

The Lockey Digital range of mechanical push button door locks offers a wide choice of functions to suit a variety of different applications.

Lockey Digital Features;

- For internal & external use - Over 7,000 non sequential code groups (when code made up from 3 to 7 digits) - Code easily changed by an authorised person (locks have been designed to eliminate unnecessary code change errors) - For single, double, rebated, narrow style & sliding doors (of varying size and widths) -Teflon coated parts to enhance operation and delay natural wear & tear - Patented options such as hook bolt for sliding doors, passage function for free entry via handle or knob and the ability to use the same code digit twice - Supplied with all necessary parts, template for drilling and complete installation instructions to ensure easy and accurate installation and smooth & problem free operation
- When it is not viable to use a 'Lockey door lock' we offer the alternative 'Lockey Key Safe Box'

Lockey models in brief:

Model ref: 2000 Series (medium duty)

2200

Surface sliding bar

2210

Mortise dead bolt

2500

Surface hook bolt (for sliding doors)

2230NL

Front only to use with specifice rim night latches & fire exit hardware

2430

Mortise latch

2435

Mortise latch with hold back

2835

Morise latch, lever handles, free passage & hold back

2435K

Mortise latch with key bypass

-Keyed to differ, Keyed alike & Keyed to master

2430DS

Double sided combination (code used on entry & exit with optional key bypass)



Model ref: Little Lockey

(medium duty, compact design)

L235

Mortise latch with hold back

L220

Surface sliding bar



Model ref: Lockey Key Safe

(for key sharing & key storing)

LKS200



Model ref: High Tech Series
(Heavy duty)

1150

Lever handles, mortise magnetic latch bolt, free passage

1650

Large easy grip knobs, mortise magnetic latch bolt, free passage



Model ref: Super 8 Series

(Medium to heavy duty, double digit option)

B8200

Mortise latch, large knob, surface sliding bar

B8235

Mortise latch bolt, large knob, hold back

7055

Lever handles, strong mortise magnetic latch bolt, hold back (Only 40mm wide, suitable for narrow style when supplied with spindle adaption kit)



Model ref: Deluxe series

(Medium duty, superb brush finishes, designed to compliment modern homes & office's)

3235

Mortise latch, easy grip knob, hold back



For more information please contact:

Total Product Sales Ltd

Unit 10 Orchard Rd

Royston, Hertfordshire

SG8 5HD

Tel: + 44 (0) 1763 245245

Email: info@totalproductsales.co.uk

www.lockeydigitaldoorlocks.co.uk

Lockey Digital Door Locks

2000 Series

2200
2210
2340
2435
2835
2500
2230NL
2435KD
2430DS



The Lockey 2000 series offers a range of different functions based on our original Lockey Digital door lock design, manufactured & distributed worldwide since 1982,

- Unlocks on entering of correct code (optional key bypass)
- Non handed
- Suitable for internal & external use
- Over 7,000 code groups (when made up from 3 to 7 digits)
- Code easily changed by authorised persons
- Designed to eliminate unnecessary code change errors
- Teflon coated parts to enhance operation and delay natural wear & tear
- Knobs & handle have slipping clutch to prevent damage when forced

For long lasting 'reliable performance'



Ref 2200
Surface rim sliding bar (57mm throw)
suitable for narrow style doors, manual throw
back to re-lock
-SC, BB, AB, AC & JB finishes



Ref 2210
Mortise dead bolt (25mm throw) hardened steel
core shaft for additional security, 60mm back set,
manual throw back to re-lock
-SC, BB, AB, AC & JB finishes

www.lockeydigitaldoorlocks.co.uk

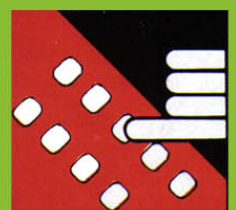



Ref 2430, 2435 & 2835
Mortise latch bolt (12mm throw, anti thrust pin) 60mm back set (optional 70mm)
auto re-lock, optional hold back (ref 2435)
full length lever handle, passage function
& hold back (ref 2835 NEW)
-SC, BB, AB, AC & JB finishes



Since 1982



Ref 2500
Surface hook bolt for patio & light industrial
sliding doors (20mm throw) for wooden, UPVC
& aluminium doors, manual throw back to re-lock,
option with key bypass
-SC finish
Patent No GB2274134A



Ref 2435KD, 2435KA & 2435KM
Key bypass to override the code, mortise latch
bolt (12mm throw, anti thrust pin) 70mm
back set (optional 60mm) auto re-lock,
optional hold back
Key options:
KD - keyed different
KA - Keyed alike (1 or more with same
cylinders & keys)
KM - Master keyed
-SC & BB finishes



Ref 2230NL
Lockey front only supplied, adapted to use together
with specified rim night latches and internal fire exit
hardware, will suit narrow style doors, option with key
bypass
-SC, BB, AB, AC & JB finishes



Ref 2430DS/10DS & 2430DSK
Double sided combination, ideal for exterior exposed
gates & where both entry & exit needs to be controlled,
Mortise latch bolt (12mm throw, anti thrust pin) 60mm or
70mm back set, auto re-lock or mortise dead bolt (25mm
throw) 60mm back set, manual throw back to re-lock
option with key bypass on one side only, KD, KA or KM
-SC & BB finishes

Finishes: SC - Satin chrome, BB - Bright brass,
AB - Antique brass, AC - Antique copper, JB - Jet Black

Total Product Sales Ltd, Unit 10 Orchard Rd,
Royston Hertfordshire, SG8 5HD

Tel: + 44 (0) 1763 245245 sales@totalproductsales.co.uk www.lockeydigitaldoorlocks.co.uk

Lockey Digital Door Locks

NEW to the
2000 series

2835



To compliment the Lockey 2000 series our NEW Lockey with reversible lever handles, not only has a hold back facility but also 'passage function' to give free access via the handles, operating the latch without using the code.

Either of these options can easily be disconnected if not required.

*For long lasting
'reliable performance'*

- For internal & external use
- Over 7,000 non sequential code groups
- Non handed (easily adapted for use on left or right handed doors)
- Code easily changed by authorised persons
- Designed to eliminate unnecessary code change errors
- Teflon coated parts to enhance operation and delay natural wear & tear
- Handles have slipping clutch to prevent damage when forced

www.lockeydigitaldoorlocks.co.uk





Since 1982

Ref 2835

Mortise latch bolt (12mm throw,
anti thrust pin) 60mm back set,
(optional 70mm)
auto re-lock, hold back & free passage
function
-SC, BB, AC, AB & JB finishes

The Lockey 2835 can be used to upgrade existing 2430/2435 installations
should full length levers be required, without the need to re-install.



Available in the following finishes:

Satin chrome, Antique brass, Bright brass, Antique copper & Jet black to
compliment the majority of other general hardware fixtures, fittings & door finishes.

Finishes: SC - Satin chrome, BB - Bright brass,
AB - Antique brass, AC - Antique copper, JB - Jet Black

Total Product Sales Ltd, Unit 10 Orchard Rd,
Royston Hertfordshire, SG8 5HD

Tel: + 44 (0) 1763 245245 sales@totalproductsales.co.uk www.lockeydigitaldoorlocks.co.uk

Lockey Digital Door Locks

High Tech Series

1150
1650

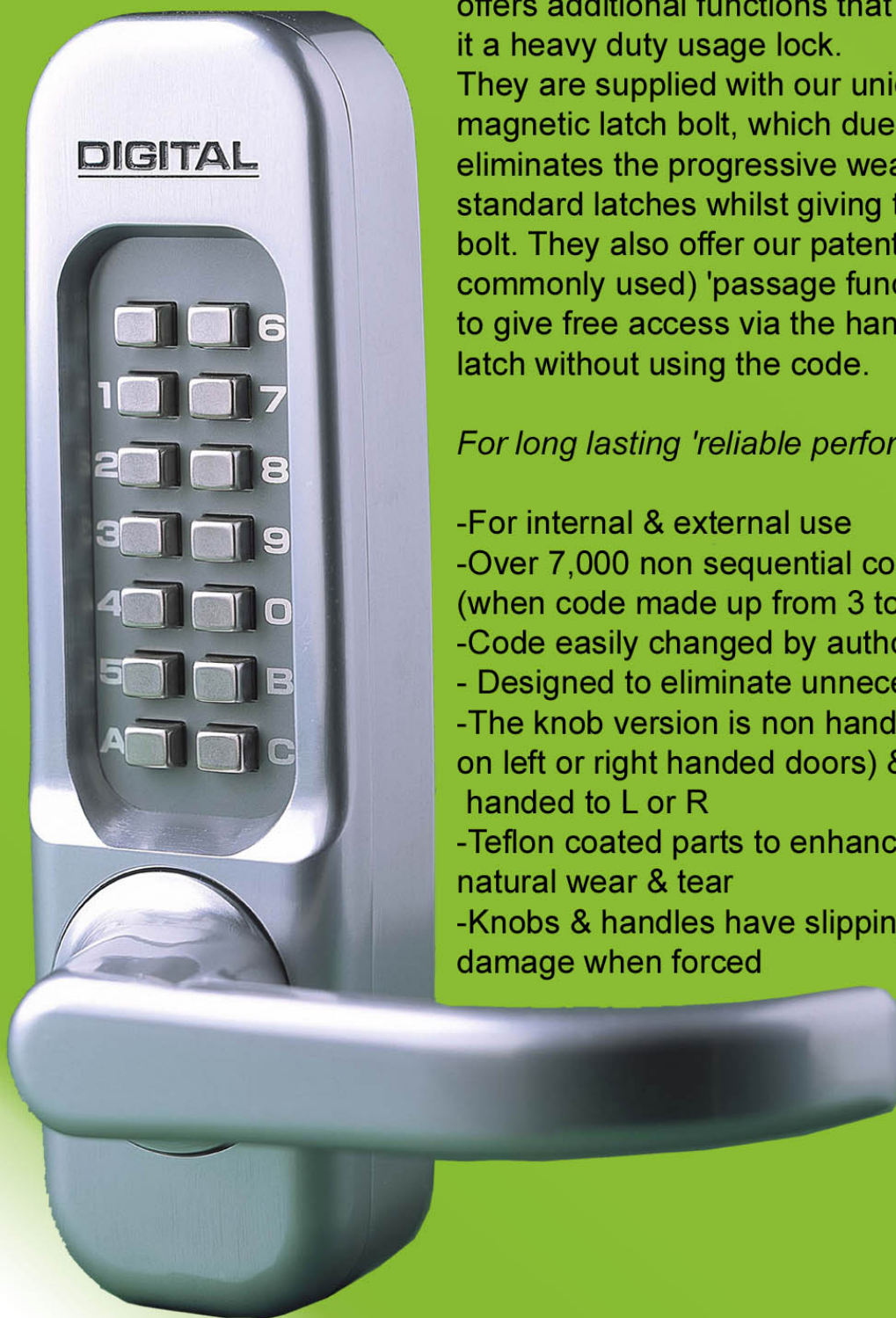

The Lockey High Tech series offers additional functions that make it a heavy duty usage lock. They are supplied with our unique patented magnetic latch bolt, which due to it's design eliminates the progressive wear & tear of standard latches whilst giving the strength of a bolt. They also offer our patented (though now commonly used) 'passage function' with anti pick plate to give free access via the handles or knobs operating the latch without using the code.

For long lasting 'reliable performance'

- For internal & external use
- Over 7,000 non sequential code groups (when code made up from 3 to 7 digits)
- Code easily changed by authorised persons
- Designed to eliminate unnecessary code change errors
- The knob version is non handed (easily adapted for use on left or right handed doors) & the handle version is handed to L or R
- Teflon coated parts to enhance operation and delay natural wear & tear
- Knobs & handles have slipping clutch to prevent damage when forced

www.lockeydigitaldoorlocks.co.uk





Since 1982



Ref 1150

Lever handles (handed L or R)
mortise magnetic latch bolt (13.5mm
throw when in locked position) 60mm
back set, standard sprung latch available
on request. A heavy duty usage lock,
passage function

-SC & BB finishes

Lock Patent No GB2309259A

Magnetic Latch Patent No GB2286627A



Ref 1650

Large rubber grip knobs (non
handed) mortise magnetic latch bolt
(13.5mm throw when in locked
position) 60mm back set, standard
sprung latch available on request. A
heavy duty usage lock, passage function
-SC finish

Lock Patent No GB2309259A

Magnetic Latch Patent No GB2286627A



Ref 1150DS

Combination on both sides,
ideal for exterior gates in exposed
locations. Mortise magnetic latch bolt
(13.5mm throw when in locked
position) 60mm back set, standard
sprung latch available on request. A
heavy duty usage lock, passage function
-SC finish

Lock Patent No GB2309259A

Magnetic Latch Patent No GB2286627A

Finishes: SC - Satin chrome, BB - Bright brass,
AB - Antique brass, AC - Antique copper, JB - Jet Black

Total Product Sales Ltd, Unit 10 Orchard Rd,
Royston Hertfordshire, SG8 5HD

Tel: + 44 (0) 1763 245245 sales@totalproductsales.co.uk www.lockeydigitaldoorlocks.co.uk

Lockey Digital Door Locks

Super 8 & Deluxe Series

7055
B8235
3235DX

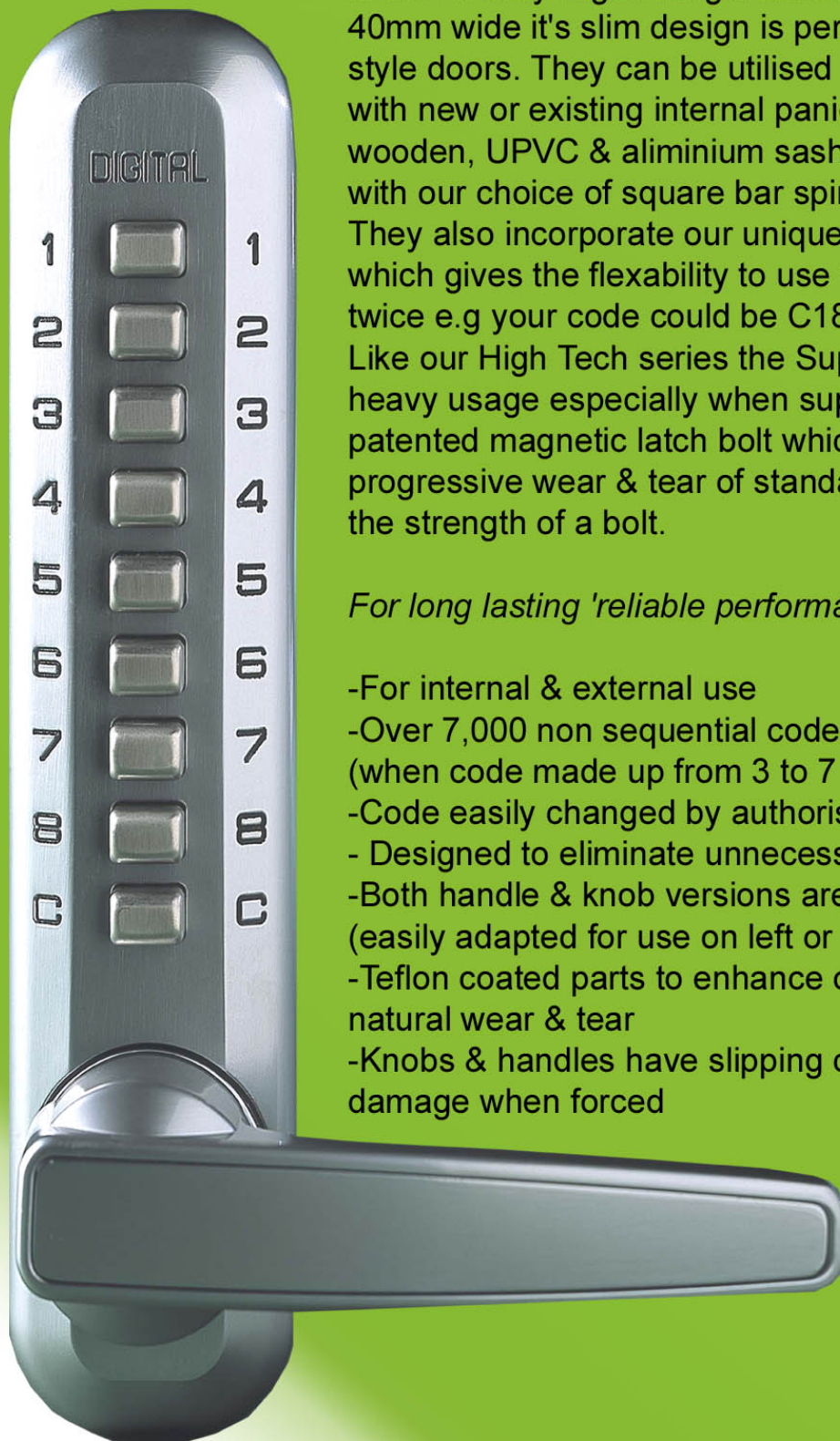

The Lockey Super 8 series add's a new dimension the the usages of the Lockey Digital range. Measuring only 40mm wide it's slim design is perfect for narrow style doors. They can be utilised 'for example' with new or existing internal panic hardware and wooden, UPVC & aliminium sash locks when supplied with our choice of square bar spindles.

They also incorporate our unique patented code chamber which gives the flexibility to use the same code digit twice e.g your code could be C18227 or C44773.

Like our High Tech series the Super 8's are designed for heavy usage especially when supplied with our unique patented magnetic latch bolt which eliminates the progressive wear & tear of standard latches whilst giving the strength of a bolt.

For long lasting 'reliable performance'

- For internal & external use
- Over 7,000 non sequential code groups (when code made up from 3 to 7 digits)
- Code easily changed by authorised persons
- Designed to eliminate unnecessary code change errors
- Both handle & knob versions are non handed (easily adapted for use on left or right handed doors)
- Teflon coated parts to enhance operation and delay natural wear & tear
- Knobs & handles have slipping clutch to prevent damage when forced

www.lockeydigitaldoorlocks.co.uk





Since 1982



Ref Super 8 7055

Lever handles (non handed) 40mm wide, mortise magnetic latch bolt (13.5mm throw when in locked position) 60mm back set, or standard sprung latch available on request. A medium to heavy duty usage lock, optional hold back

-SC & BB finishes

Optional square bar spindles available to use with new or existing panic hardware & sash locks.

Lock Patent No GB2381826B

Magnetic Latch Patent No GB2286627A



Ref Super 8 B8235

Large easy grip knobs (non handed)

40mm wide, mortise latch bolt

(12mm throw, anti thrust pin)

60mm back set. A medium to heavy duty usage lock, optional hold back.

Also available as 8200 surface rim sliding bar

-SC finish

Lock Patent No GB2381826B

Magnetic Latch Patent No GB2286627A



Ref Deluxe 3235

Mortise latch bolt (12mm throw, anti thrust pin) 60mm back set (optional 70mm) auto re-lock, optional hold back.

Also available as 3200DX surface rim sliding bar

-SC, AB, AC finishes

Designed to compliment modern homes & offices

Finishes: SC - Satin chrome, BB - Bright brass,
AB - Antique brass, AC - Antique copper, JB - Jet Black

Total Product Sales Ltd, Unit 10 Orchard Rd,
Royston Hertfordshire, SG8 5HD

Tel: + 44 (0) 1763 245245 sales@totalproductsales.co.uk www.lockeydigitaldoorlocks.co.uk

Lockey Digital Door Locks

'Little' Lockey Series

L235
L220



For long lasting 'reliable performance'

- For internal & external use
- Over 4,500 non sequential code groups
- Non handed
- Code easily changed by authorised persons
- Designed to eliminate unnecessary code change errors
- Teflon coated parts to enhance operation and delay natural wear & tear
- Knobs have slipping clutch to prevent damage when forced
- Patented 'turn knob to clear device'

Our 'Little' Lockey is based on the Lockey 2000 series but is more compact in design, with the elimination of the C to clear button. Measuring in at only 125mm in height and 37mm wide. Currently in 3 finishes, with a choice of auto locking (latch bolt) or manual re-lock (surface rim sliding bar). The surfacerim bolt is the simple solution for easy installation requiring only 3 holes to be drilled.

It is also more suited if space is an issue eg cupboards, post boxes etc because it can be fitted as close to the door edge as required.

Our new Lockey is less conspicuous so will blend in well with general house hold fixtures & fittings for example a home office/study.

www.lockeydigitaldoorlocks.co.uk





Since 1982

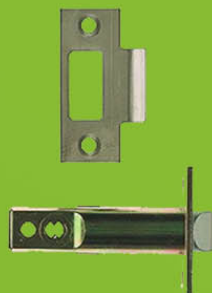
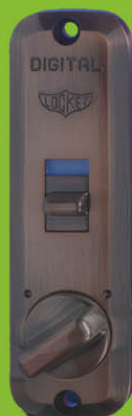

Ref L235
Mortise latch bolt (12mm throw,
anti thrust pin) 60mm back set,
auto re-lock, optional hold back
-SC, BB & AC finishes
Lock Patent No GB2412693



Ref L220
Surface rim sliding bar (57mm throw)
suitable for narrow style doors, manual
throw back to re-lock
-SC, BB & AC finishes
Lock Patent No GB2412693

'Little' Lockey
on post box



Finishes: SC - Satin chrome, BB - Bright brass,
AB - Antique brass, AC - Antique copper, JB - Jet Black

Total Product Sales Ltd, Unit 10 Orchard Rd,
Royston Hertfordshire, SG8 5HD

Tel: + 44 (0) 1763 245245 sales@totalproductsales.co.uk www.lockeydigitaldoorlocks.co.uk

Lockey Digital

Key Safe Box

LKS200

NEW

From The Lockey Digital Door Lock Range
Our new Key Safe has been designed utilising an existing Lockey product to maintain the Lockey Digital standard of quality and to ensure Lockey Digital reliability & performance.

Based on our patented 'Little Lockey design' with 12 push buttons 'having eliminated the need for the 'C' to clear button and using our patented passage 'open' function with a latch cam, the 'Little' Lockey alters to become a removable front cover from a back box by means of a code combination.

The Lockey Digital Key Safe is an ideal solution for the control of keys '*always knowing where your keys are*'.

It allows only people with the correct code to gain access to a key or keys by entering their chosen code combination. The code can be changed quickly & easily.

Operates like a digital door lock and looks like a digital door lock. They can be used indoors & outdoors, preferably installed in a concealed, discreet position.



The key safe can be used to store & share house keys, shed, lock up and garage keys, filing cabinet and cupboard keys, padlock & emergency keys.

Especially convenient for remote sites or when it is not always possible for physical key hand overs.

Can be used by:

Care workers, children & families, cleaners, delivery companies, holiday home lets, local authorities & employees 'just a few examples'



www.lockeydigitaldoorlocks.co.uk

The Lockey Key Safe is currently available in four finishes 'brown, green, satin chrome and terraccota' to blend in with various different settings.



Since 1982

Model ref:



LKS200/B

LKS200/G

LKS200/SC

LKS200/T



The Key Safe comes supplied with the necessary fixing screws and code change tools.



138mm

50mm



From key
peg to
key ledge

85mm



'IMPORTANT'
depth for keys

12mm

Patent application number 0719472.3

Finishes: SC - Satin chrome, B - Brown,
G - Green, T - Terraccota

Total Product Sales Ltd, Unit 10 Orchard Rd,
Royston Hertfordshire, SG8 5HD

Tel: + 44 (0) 1763 245245 sales@totalproductsales.co.uk www.lockeydigitaldoorlocks.co.uk